

INSTRUCTION MANUAL

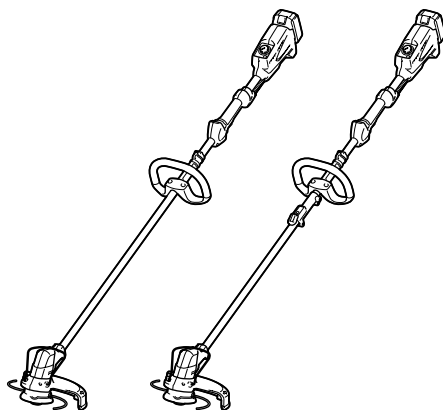

Cordless Grass Trimmer

DUR142L
DUR182L
DUR183L



014149

IMPORTANT: Read Before Using.

ENGLISH (Original instructions)

SPECIFICATIONS

Model	DUR142L	DUR182L	DUR183L
Type of pipe	Integrated pipe		Splittable pipe
No load speed	3,500 - 6,000 min ⁻¹		
Overall length with nylon cutting head	1,843 mm		
Split length	-	982 mm	
Cutting diameter with nylon cutting head	300 mm		
Net weight	3.8 kg	3.9 kg	4.1 kg
Rated voltage	D.C. 14.4 V	D.C. 18 V	
 Standard battery cartridge and charger Always keep the combinations of battery/charger on the right columns.	BL1415N, BL1430, BL1440 / DC18RC	BL1815N, BL1820, BL1830, BL1840, BL1850 / DC18RC	

- Due to our continuing program of research and development, the specifications herein are subject to change without notice.
- Specifications and battery cartridge may differ from country to country.
- Weight, with battery cartridge, according to EPTA-Procedure 01/2003

Noise	Sound pressure level		Applicable standard or directive	
	Model	L _{PA} (dB (A))		Uncertainty K (dB (A))
	DUR142L	78	1.0	2000/14/EC
	DUR182L / DUR183L	79	0.7	

- Even if the sound pressure level listed above is 80 dB (A) or less, the level under working may exceed 80 dB (A). Wear ear protection.

Vibration	Front grip		Rear grip		Applicable standard or directive	
	Model	a _h (m/s ²)	Uncertainty K (m/s ²)	a _h (m/s ²)		Uncertainty K (m/s ²)
	DUR142L	≤ 2.5	1.5	≤ 2.5	1.5	EN786
	DUR182L / DUR183L	≤ 2.5	1.5	≤ 2.5	1.5	

ENG901-1

END020-3









- The declared vibration emission value has been measured in accordance with the standard test method and may be used for comparing one tool with another.
- The declared vibration emission value may also be used in a preliminary assessment of exposure.

WARNING:

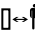
- The vibration emission during actual use of the power tool can differ from the declared emission value depending on the ways in which the tool is used.
- Be sure to identify safety measures to protect the operator that are based on an estimation of exposure in the actual conditions of use (taking account of all parts of the operating cycle such as the times when the tool is switched off and when it is running idle in addition to the trigger time).

Symbols

The following show the symbols used for the equipment. Be sure that you understand their meaning before use.

-  Take particular care and attention.
-  Read instruction manual.
-  Danger; be aware of thrown objects.
-  The distance between the tool and bystanders must be at least 15 m.
-  Keep bystanders away.
-  Keep distance at least 15 m.
-  Wear a helmet, goggles and ear protection.
-  Wear protective gloves.
-  Wear sturdy boots with nonslip soles. Steeltoed safety boots are recommended.

31.12.2013



000331

Yasushi Fukaya
Director

Makita, Jan-Baptist Vinkstraat 2, 3070, Belgium

GEB109-3



- Do not expose to moisture.



- Top permissible tool speed.



- Never use metal blade.



- Only for EU countries
Do not dispose of electric equipment or battery pack together with household waste material!

In observance of the European Directives, on Waste Electric and Electronic Equipment and Batteries and Accumulators and Waste Batteries and Accumulators and their implementation in accordance with national laws, electric equipment and batteries and battery pack(s) that have reached the end of their life must be collected separately and returned to an environmentally compatible recycling facility.

ENH219-3

For European countries only

EC Declaration of Conformity

Makita declares that the following Machine(s):

Designation of Machine:

Cordless Grass Trimmer

Model No./ Type: DUR142L, DUR182L, DUR183L

Specifications: see "SPECIFICATIONS" table.

Conforms to the following European Directives:

2000/14/EC, 2006/42/EC

They are manufactured in accordance with the following standard or standardized documents:

EN60335

The technical file in accordance with 2006/42/EC is available from:

Makita, Jan-Baptist Vinkstraat 2, 3070, Belgium

The conformity assessment procedure required by Directive 2000/14/EC was in Accordance with annex VI

Notified Body:

TÜV Rheinland LGA Products GmbH

Tillystraße 2

90431 Nürnberg, Germany

Identification number 0197

Model DUR142L

Measured Sound Power Level: 89 dB (A)

Guaranteed Sound Power Level: 90 dB (A)

Model DUR182L, DUR183L

Measured Sound Power Level: 90 dB (A)

Guaranteed Sound Power Level: 90 dB (A)

IMPORTANT SAFETY INSTRUCTIONS

⚠ WARNING! Read all safety warnings and all instructions. Failure to follow the warnings and instructions may result in electric shock, fire and/or serious injury.

Save all warnings and instructions for future reference.

1. Be familiar with the controls and proper use of the equipment.
2. Cutting elements continue to rotate after the motor is switched off.
3. Never allow children or people unfamiliar with the instructions to use the machine.
4. Stop using the machine while people, especially children, or pets are nearby.
5. Only use the machine in daylight or good artificial light.
6. Before using the machine and after any impact, check for signs of wear or damage and repair as necessary.
7. Take care against injury from any device fitted for trimming the filament line length. After extending new cutter line always return the machine to its normal operating position before switching on.
8. Never fit metal cutting elements.
9. This appliance is not intended for use by persons (including children) with reduced physical, sensory or mental capabilities, or lack of experience and knowledge, unless they have been given supervision or instruction concerning use of the appliance by a person responsible for their safety. Children should be supervised to ensure that they do not play with the appliance.
10. Use the tool with the utmost care and attention.
11. Operate the tool only if you are in good physical condition. Perform all work calmly and carefully. Use common sense and keep in mind that the operator or user is responsible for accidents or hazards occurring to other people or their property.

12. **Never operate the tool when tired, feeling ill or under the influence of alcohol or drugs.**
13. **The tool should be switched off immediately if it shows any signs of unusual operation.**

Intended use of the tool

1. **Use right tool. The cordless grass trimmer is only intended for cutting grass, light weeds. It should not be used for any other purpose such as hedge cutting as this may cause injury.**

Personal protective equipment

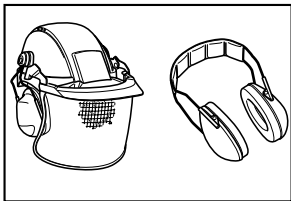

010820

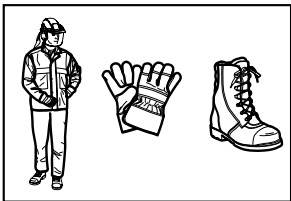

010821

1. **Dress Properly.** The clothing worn should be functional and appropriate, i.e. it should be tight-fitting but not cause hindrance. Do not wear either jewelry or clothing which could become entangled with high grass. Wear protective hair covering to contain long hair.
2. **When using the tool, always wear sturdy shoes with a non-slip sole.** This protects against injuries and ensures a good footing.
3. **Wear protective glasses or goggles.**

Electrical and battery safety

1. **Avoid dangerous environment.** Don't use the tool in damp or wet locations or expose it to rain. Water entering the tool will increase the risk of electric shock.
2. **Recharge only with the charger specified by the manufacturer.** A charger that is suitable for one type of battery pack may create a risk of fire when used with another battery pack.
3. **Use power tools only with specifically designated battery packs.** Use of any other battery packs may create a risk of injury and fire.

4. **When battery pack is not in use, keep it away from other metal objects, like paper clips, coins, keys, nails, screws or other small metal objects, that can make a connection from one terminal to another. Shorting the battery terminals together may cause burns or a fire.**
5. **Under abusive conditions, liquid may be ejected from the battery; avoid contact.** If contact accidentally occurs, flush with water. If liquid contacts eyes, seek medical help. Liquid ejected from the battery may cause irritation or burns.
6. **Do not dispose of the battery(ies) in a fire.** The cell may explode. Check with local codes for possible special disposal instructions.
7. **Do not open or mutilate the battery(ies).** Released electrolyte is corrosive and may cause damage to the eyes or skin. It may be toxic if swallowed.

Starting up the tool

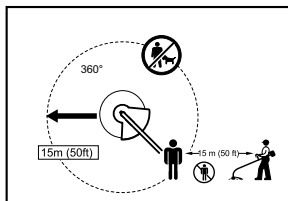

012858

1. **Make sure that there are no children or other people within a working range of 15 meters (50 ft), also pay attention to any animals in the working vicinity.** Otherwise stop using the tool.
2. **Before use always check that the tool is safe for operation.** Check the security of the cutting tool and the guard and the switch trigger/lever for easy and proper action. Check for clean and dry handles and test the on/off function of the switch.
3. **Check damaged parts before further use of the tool.** A guard or other part that is damaged should be carefully checked to determine that it will operate properly and perform its intended function. Check for alignment of moving parts, binding of moving parts, breakage of parts, mounting, and any other condition that may affect its operation. A guard or other part that is damaged should be properly repaired or replaced by our authorized service center unless indicated elsewhere in this manual.
4. **Switch on the motor only when hands and feet are away from the cutting tool.**

5. Before starting make sure that the cutting tool has no contact with hard objects such as branches, stones etc. as the cutting tool will revolve when starting.

Method of operation

1. Never operate the machine with damaged guards or without the guards in place.
 2. Only use the tool in good light and visibility. During the winter season beware of slippery or wet areas, ice and snow (risk of slipping). Always ensure a safe footing.
 3. Take care against injury to feet and hands from the cutting tool.
 4. Keep hands and feet away from the cutting means at all times and especially when switching on the motor.
 5. Never cut above waist height.
 6. Never stand on a ladder and run the tool.
 7. Never work on unstable surfaces.
 8. Don't overreach. Keep proper footing and balance at all times.
 9. Remove sand, stones, nails etc. found within the working range. Foreign particles may damage the cutting tool and can cause to be thrown away, resulting in a serious injury.
 10. Should the cutting tool hit stones or other hard objects, immediately switch off the motor and inspect the cutting tool.
 11. Before commencing cutting, the cutting tool must have reached full working speed.
 12. During operation always hold the tool with both hands. Never hold the tool with one hand during use. Always ensure a safe footing.
 13. All protective equipment such as guards supplied with the tool must be used during operation.
 14. Except in case of emergency, never drop or cast the tool to the ground or this may severely damage the tool.
 15. Never drag the tool on the ground when moving from place to place, the tool may become damaged if moved in this manner.
 16. Always remove the battery cartridge from the tool:
 - whenever leaving the tool unattended;
 - before clearing a blockage;
 - before checking, cleaning or working on the tool;
 - before making any adjustments, changing accessories or storing;
 - whenever the tool starts vibrating unusually;
 - whenever transporting the tool.
17. Don't force the tool. It will do the job better and with less likelihood of a risk of injury at the rate for which it was designed.

Maintenance instructions

1. The condition of the cutting tool, protective devices and shoulder strap must be checked before commencing work.
2. Turn off the motor and remove the battery cartridge before carrying out maintenance, replacing the cutting tool and cleaning the tool.
3. After use, disconnect the battery cartridge from the tool and check for damage.
4. Check for loose fasteners and damaged parts such as nearly halfway cut-off state in the cutting tool.
5. When not in use store the equipment in a dry location that is locked up or out of children's reach.
6. Use only the manufacturer's recommended replacement parts and accessories.
7. Always ensure that ventilation openings are kept clear of debris.
8. Inspect and maintain the tool regularly, especially before/after use. Have the tool repaired only by our authorized service center.
9. Keep handles dry, clean and free from oil and grease.

SAVE THESE INSTRUCTIONS.

WARNING:

DO NOT let comfort or familiarity with product (gained from repeated use) replace strict adherence to safety rules for the subject product. MISUSE or failure to follow the safety rules stated in this instruction manual may cause serious personal injury.

ENC007-B

IMPORTANT SAFETY INSTRUCTIONS

FOR BATTERY CARTRIDGE

1. Before using battery cartridge, read all instructions and cautionary markings on (1) battery charger, (2) battery, and (3) product using battery.
2. Do not disassemble battery cartridge.
3. If operating time has become excessively shorter, stop operating immediately. It may result in a risk of overheating, possible burns and even an explosion.

-
4. If electrolyte gets into your eyes, rinse them out with clear water and seek medical attention right away. It may result in loss of your eyesight.
 5. Do not short the battery cartridge:
 - (1) Do not touch the terminals with any conductive material.
 - (2) Avoid storing battery cartridge in a container with other metal objects such as nails, coins, etc.
 - (3) Do not expose battery cartridge to water or rain.

A battery short can cause a large current flow, overheating, possible burns and even a breakdown.

6. Do not store the tool and battery cartridge in locations where the temperature may reach or exceed 50 ° C (122 ° F).
7. Do not incinerate the battery cartridge even if it is severely damaged or is completely worn out. The battery cartridge can explode in a fire.
8. Be careful not to drop or strike battery.
9. Do not use a damaged battery.
10. Follow your local regulations relating to disposal of battery.

SAVE THESE INSTRUCTIONS.

Tips for maintaining maximum battery life

1. Charge the battery cartridge before completely discharged.

Always stop tool operation and charge the battery cartridge when you notice less tool power.
2. Never recharge a fully charged battery cartridge.

Overcharging shortens the battery service life.
3. Charge the battery cartridge with room temperature at 10 ° C - 40 ° C (50 ° F - 104 ° F). Let a hot battery cartridge cool down before charging it.
4. Charge the battery cartridge once in every six months if you do not use it for a long period of time.

PARTS DESCRIPTION

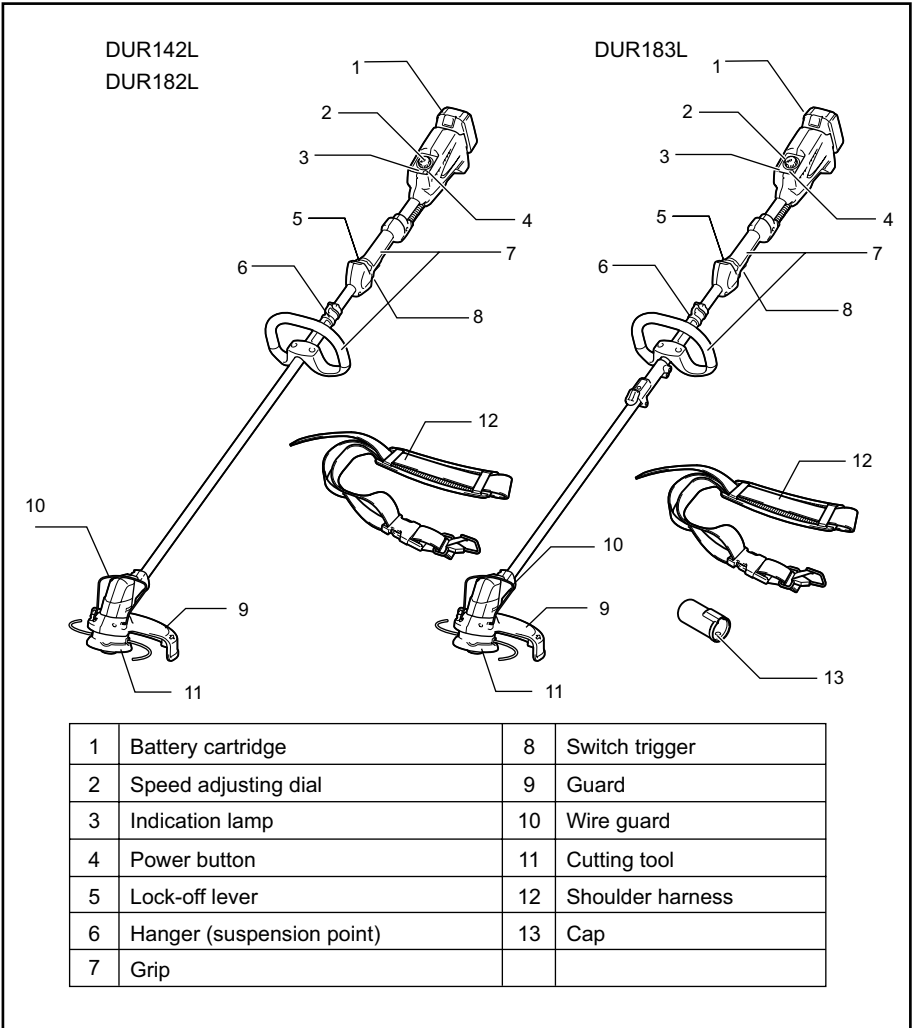

014160

FUNCTIONAL DESCRIPTION

⚠WARNING:

- **Always be sure that the tool is switched off and battery cartridge is removed before adjusting or checking the functions on the tool.** Failure to switch off and remove the battery cartridge may result in serious personal injury from accidental start-up.

Installing or removing battery cartridge

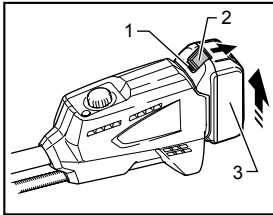

1. Red indicator
2. Button
3. Battery cartridge

013921

⚠CAUTION:

- Always switch off the tool before installing or removing of the battery cartridge.
- **Hold the tool and the battery cartridge firmly when installing or removing battery cartridge.** Failure to hold the tool and the battery cartridge firmly may cause them to slip off your hands and result in damage to the tool and battery cartridge and a personal injury.

To remove the battery cartridge, slide it from the tool while sliding the button on the front of the cartridge.

To install the battery cartridge, align the tongue on the battery cartridge with the groove in the housing and slip it into place. Insert it all the way until it locks in place with a little click. If you can see the red indicator on the upper side of the button, it is not locked completely.

⚠CAUTION:

- Always install the battery cartridge fully until the red indicator cannot be seen. If not, it may accidentally fall out of the tool, causing injury to you or someone around you.
- Do not install the battery cartridge forcibly. If the cartridge does not slide in easily, it is not being inserted correctly.

Power switch action

⚠WARNING:

- **Before inserting the battery cartridge in the tool, always check to see that the switch trigger actuates properly and returns to the "OFF" position when released. Do not pull the switch trigger hard without turning the lock-off lever. This can cause switch breakage.** Operating a tool with a switch that does not actuate properly can lead to loss of control and serious personal injury.

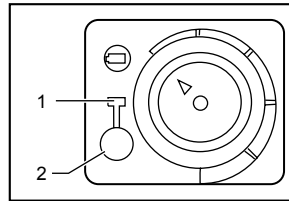

1. Power indicator
2. Power button

013834

Push the power button on the housing so that the tool is powered on and power indicator lights.

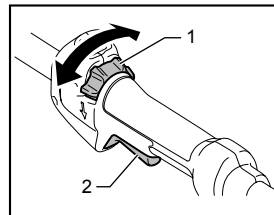

1. Lock-off lever
2. Switch trigger

014158

To prevent the switch trigger from being accidentally pulled, a lock-off lever is provided.

To start the tool, turn the lock-off lever and then pull the switch trigger. Release the switch trigger to stop.

NOTE:

- After the power button is pushed and the tool is left one minute without any operations, the tool is automatically powered off.

Reversing Switch for Debris Removal

⚠WARNING:

- **Always be sure that the tool is switched off and battery cartridge is removed before removing weeds or debris entangled in the tool that could not be removed when operated in the reverse mode.** Failure to switch off and remove the battery cartridge may result in serious personal injury from accidental start-up.

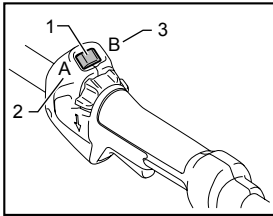

1. Reversing switch
2. A position depressed for normal operation
3. B position depressed for weed and debris removal

014159

This tool has a reversing switch which is only provided to change the direction of rotation so that it can be used to remove weeds and debris entangled in the tool. To operate the tool normally the "A" side of the switch should be depressed.

To remove weeds and debris that are jammed in the rotating head the tool can be reversed by depressing the "B" side of the switch. In the reverse position the tool will only operate for a short period of time and automatically shut off.

NOTICE:

- Always check the direction of rotation before operation.
- Use the reversing switch only after the tool comes to a complete stop. Changing the direction of rotation before the tool stops may damage it.

Speed adjusting dial

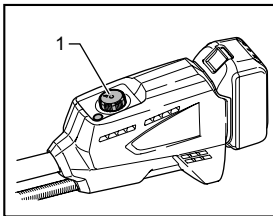

1. Speed adjusting dial

013922

The tool speed can be infinitely adjusted from 3,500 min⁻¹ to 6,000 min⁻¹ with the speed adjusting dial.

Turn the speed adjusting dial clockwise for higher speed, and counterclockwise for lower speed.

**Battery protection system
(Lithium-ion battery with star marking)**

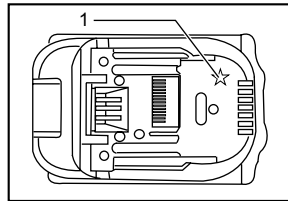

1. Star marking

012128

Lithium-ion batteries with a star marking are equipped with a protection system. This system automatically cuts off power to the tool to extend battery life.

The tool will automatically stop during operation if the tool and/or battery are placed under one of the following conditions:

- **Overloaded:**
 - The tool is operated in a manner that causes it to draw an abnormally high current. In this situation, release the switch trigger on the tool and stop the application that caused the tool to become overloaded. Then pull the switch trigger again to restart. If the tool does not start, the battery is overheated. In this situation, let the battery cool before pulling the switch trigger again.
- **Low battery voltage:**
 - The remaining battery capacity is too low and the tool will not operate. In this situation, remove and recharge the battery.

Indication lamps

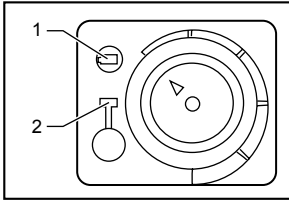



1. Battery indicator
2. Power indicator

013836

When the protection system works during the operation, the lamps light up.

Refer to the following table for the status and action to be taken for the indication lamp.

Power indicator	Battery indicator	Status	Action to be taken
			
/	Blinking	Battery power has been nearly used up.	Replace the battery with fully charged one.
/	Lighting Up	Battery protector is shutting off the power - battery power has been used up.	Replace the battery with fully charged one.
Blinking	/	Overheat protector is shutting off the power - overheating.	Rest and cool down the equipment for a while.

013900

Nylon cutting head

NOTICE:

- Do not attempt to bump feed the head while the tool is operating at a high RPM. Bump feeding at a high RPM may cause damage to the nylon cutting head.
- The bump feed will not operate properly if the head is not rotating.

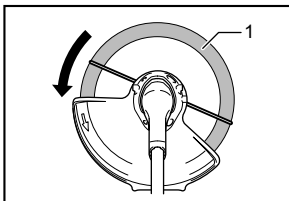

1. Most effective cutting area

013811

The nylon cutting head is a dual grass trimmer head provided with a bump & feed mechanism.

To cause the nylon cord to feed out, the cutting head should be bumped against the ground while rotating at a low RPM.

NOTE:

If the nylon cord does not feed out while bumping the head, rewind/replace the nylon cord by following the procedures described under "Maintenance."

ASSEMBLY

⚠ WARNING:

- **Always be sure that the tool is switched off and battery cartridge is removed before carrying out any work on the tool.** Failure to switch off and remove the battery cartridge may result in serious personal injury from accidental start-up.
- **Never start the tool unless it is completely assembled.** Operation of the tool in a partially assembled state may result in serious personal injury from accidental start-up.

Mounting the attachment pipe

Only for model DUR183L

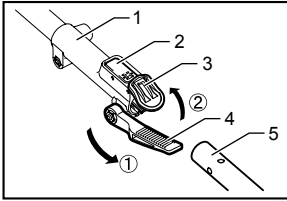

013831

To mount the attachment to a power unit:

1. Make sure that the lever is not tightened.
2. To open the entrance of the joint, depress the joint cover.

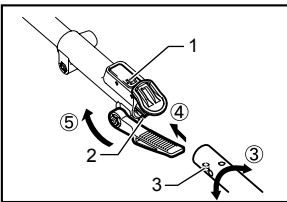

013832

3. Align the protrusion on the pipe (cutting tool side) with the concave portion of the joint part.
4. Insert the attachment pipe into the joint part. Make sure that the surface of the lock lever is horizontal to the pipe.
5. Tighten the lever firmly as shown.

To remove the attachment, loosen the lever, press the front part of the lock lever and then slide the pipe.

Installing the grip

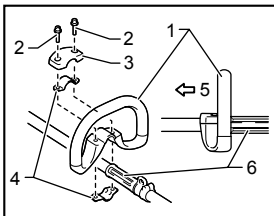

014155

Fit the grip onto the shaft pipe and tighten it with two hex bolts. Make sure that the spacer on the shaft pipe is located between the grip assembly and the other grip. Do not remove or shrink the spacer.

⚠CAUTION:

- For model DUR183L, never install the grip on the joint.

Installing the guard

⚠WARNING:

- **Never use the tool without the guard illustrated in place.** Failure to do so can cause serious personal injury.

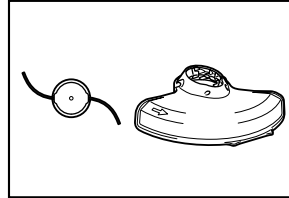

013813

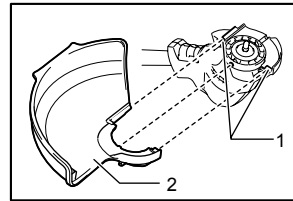

013839

Align the protrusions on the protector with the grooves of the motor housing.

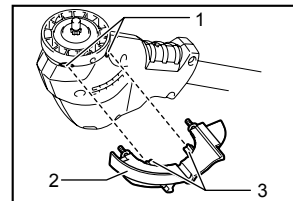

013838

Align the protrusions on the protector holder with the concave portions of the motor housing. Insert the protector holder to the motor housing.

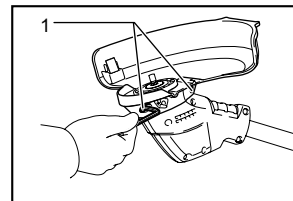

014185

After attaching the protector and the protector holder to the motor housing, tighten the hex bolts securely.

Installing the wire guard

⚠CAUTION:

- Before adjusting the wire guard, wait for the cutting head comes to standstill. Do not adjust the wire guard with your foot.

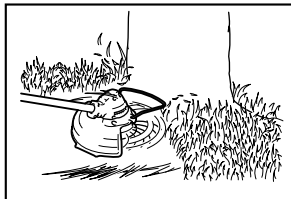

013843

To reduce the risk damaging the objects in front of the cutting head, insert the wire guard so that it controls the cutting range of the mowing line.

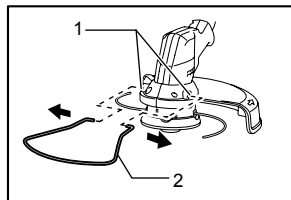

1. Holes
2. Wire guard

013841

Slightly expand the wire guard outward and then insert it into the holes of the protector.

NOTE:

- Do not expand the wire guard outward too much. Otherwise it may break.

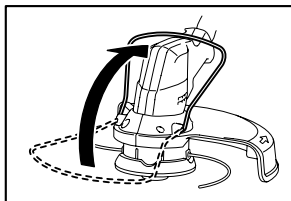

013842

When wire guard is not in use, lift it for the idle position.

Installing nylon cutting head

NOTICE:

- Be sure to use genuine Makita nylon cutting head. Turn the tool upside down so that you can replace the nylon cutting head easily.

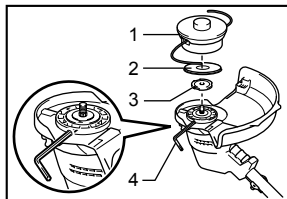

1. Nylon cutting head
2. Metal guard
3. Receive washer
4. Hex wrench

013817

Insert the hex wrench through the hole on the protector cover and the motor housing and rotate the receive washer until it is locked with the hex wrench. Mount the metal guard, the nylon cutting head onto the threaded spindle directly and tighten it by turning it counterclockwise. Remove the hex wrench.

To remove the nylon cutting head, turn the nylon cutting head clockwise while holding the receive washer with the hex wrench.

⚠CAUTION:

- If during operation the nylon cutting head accidentally impacts a rock or hard object the trimmer should be stopped and inspected for any damage. If the nylon cutting head is damaged it should be replaced immediately. Use of a damaged nylon cutting head could result in serious personal injury.

OPERATION

Correct handling of tool

Attachment of shoulder harness

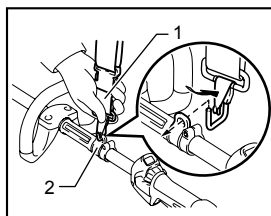

1. Buckle
2. Hook

014156

Put the shoulder harness on. Then connect the buckles on both the hook and the harness. Be sure that the buckles click and lock completely in place.

Only for model DUR183L

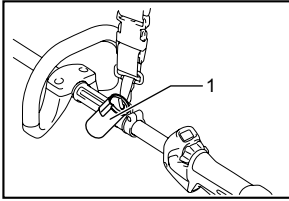

1. Cap

014165

When the cap is not in use, hang it on the hook.

Detachment

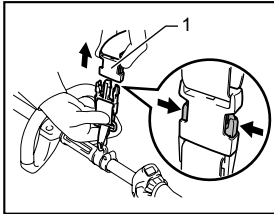

1. Buckle

014157

The buckle is provided with a means of quick release. Simply squeeze the sides and the buckle to release the tool.

⚠WARNING:

- **Be extremely careful to maintain control of the tool at all times. Do not allow the tool to be deflected toward you or anyone in the work vicinity.** Failure to keep control of the tool could result in serious injury to the bystander and the operator.

Adjustment of the hanger position and shoulder harness

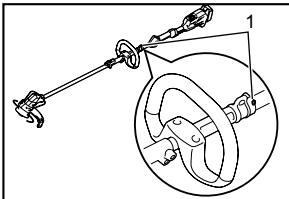

1. Hex bolt

014164

To change the hanger position, loosen the hex bolt on the hanger with the supplied wrench. Then move the hanger.

After adjusting the hanger position, tighten the hex bolt with the wrench securely.

MAINTENANCE

⚠WARNING:

- **Always be sure that the tool is switched off and battery cartridge is removed before attempting to perform inspection or maintenance on the tool.** Failure to switch off and remove the battery cartridge may result in serious personal injury from accidental start-up.

NOTICE:

Never use gasoline, benzene, thinner, alcohol or the like. Discoloration, deformation or cracks may result.

Replacing the nylon cord

⚠WARNING:

- **Make sure that the cover of the nylon cutting head is secured to the housing properly as described below.** Failure to properly secure the cover may cause the nylon cutting head to fly apart resulting in serious personal injury.

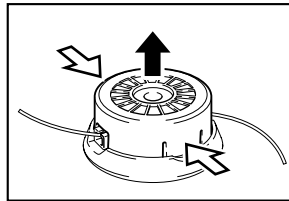

013822

Take off cover from housing, pressing two latches which are slotted section oppositely on side of housing.

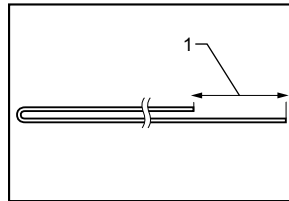

1. 80-100 mm

013823

Cut a nylon line in 3-6 m. Fold the cutting line in two halves, leave one of half longer 80-100 mm than another.

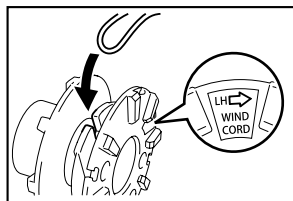

013824

Hook the middle of the new nylon cord to the notch located at the center of the spool between the 2 channels provided for the nylon cord.

Wind both ends firmly around the spool in the direction marked on the head for left hand direction indicated by LH.

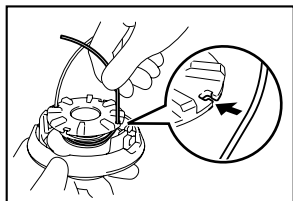

013825

Wind all but about 100 mm of the cords, leaving the ends temporarily hooked through a notch on the side of the spool.

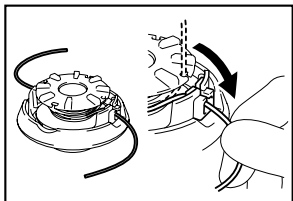

013826

Mount the spool on the cover so that the grooves and protrusions on the spool match up with those on the cover. Now, unhook the ends of the cord from their temporary position and feed the cords through the eyelets to come out of the cover.

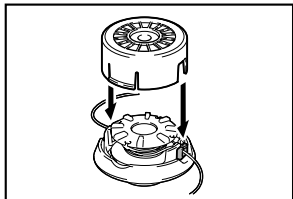

013827

Align the protrusion on the underside of the cover with the slots of the eyelets. Then push the cover firmly onto the housing to secure it. Make sure the latches fully spread in the cover.

To maintain product SAFETY and RELIABILITY, repairs, any other maintenance or adjustment should be performed by Makita Authorized Service Centers, always using Makita replacement parts.

TROUBLE SHOOTING

Before asking for repairs, conduct your own inspection first. If you find a problem that is not explained in the manual, do not attempt to dismantle the tool. Instead, ask Makita Authorized Service Centers, always using Makita replacement parts for repairs.

Malfunction status	Cause	Action
Motor does not run.	Battery cartridge is not installed.	Install the battery cartridge.
	Battery problem (under voltage)	Recharge the battery. If recharging is not effective, replace battery.
	The drive system does not work correctly.	Ask your local authorized service center for repair.
Motor stops running after a little use.	Rotation is in reverse.	Change the direction of rotation with the reversing switch.
	Battery's charge level is low.	Recharge the battery. If recharging is not effective, replace battery.
	Overheating.	Stop using of tool to allow it to cool down.
It does not reach maximum RPM.	Battery is installed improperly.	Install the battery cartridge as described in this manual.
	Battery power is dropping.	Recharge the battery. If recharging is not effective, replace battery.
	The drive system does not work correctly.	Ask your local authorized service center for repair.
Cutting tool does not rotate: stop the machine immediately!	Foreign object such as a branch is jammed between the guard and the nylon cutting head.	Remove the foreign object.
	The drive system does not work correctly.	Ask your local authorized service center for repair.
Abnormal vibration: stop the machine immediately!	One end of the nylon cord has been broken.	Bump the nylon cutting head against the ground while it is rotating to cause the cord to feed.
	The drive system does not work correctly.	Ask your local authorized service center for repair.
Cutting tool and motor cannot stop: Remove the battery immediately!	Electric or electronic malfunction.	Remove the battery and ask your local authorized service center for repair.

010856

OPTIONAL ACCESSORIES

CAUTION:

- These accessories or attachments are recommended for use with your Makita tool specified in this manual. The use of any other accessories or attachments might present a risk of injury to persons. Only use accessory or attachment for its stated purpose.

If you need any assistance for more details regarding these accessories, ask your local Makita Service Center.

- Nylon cutting head
- Nylon cord (cutting line)
- Shoulder harness
- Hex wrench
- Makita genuine battery and charger

NOTE:

- Some items in the list may be included in the tool package as standard accessories. They may differ from country to country.

Makita Jan-Baptist Vinkstraat 2, 3070, Belgium
Makita Corporation Anjo, Aichi, Japan